

Westermann Cleanmeleon II

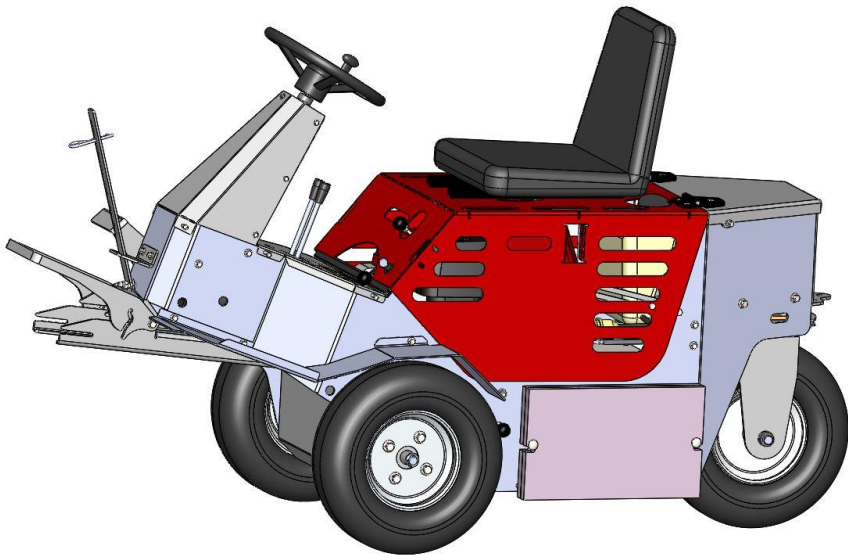

**Operating instructions and spare parts
list**

Foreword

Dear customer,

By purchasing the Westermann Cleanmeleon II, you are now in possession of a product that has been manufactured to the highest quality standards.

These operating instructions contain useful and important information relating to the operational safety, reliability and value retention of your Westermann Cleanmeleon II.

The content familiarises you with how to operate, service and maintain the vehicle. It also helps you to prevent risks and avoid damage.

We wish you the very best results with your Westermann Cleanmeleon II.

Westermann GmbH & Co.KG

Index

1. General information	1
1.1. Purpose	1
1.2. Product information	1
1.2.1 Manufacturer	1
1.2.2 Type plate	2
1.2.3 Ordering spare parts	2
1.2.4 Intended use	3
1.2.5. Technical datasheet	4
2. Safety	5
2.1. Safety information symbols in the operating instructions	5
2.2. Staff training and instruction	6
2.3. Risk of non-compliance with the safety instructions	7
2.4. Safe working practice	7
2.5. Safety instructions for the operator/user	8
2.6. Safety notice for maintenance, inspection and installation work	11
2.7. Unauthorised modifications and production of spare parts	12
2.8. Inadmissible modes of operation	12
2.9. Warning symbols on the machine according to ISO 11684	13
3. Westermann Cleanmeleon II	14
3.1. Typeplate (identification)	14
3.2. Storage	15
3.3. Description of product and accessories	16
3.4. Attachments	17
3.5. Installing the attachments	18
3.5.1. Attachment to swing arm	18
3.5.2. Attachment to swing arm with attachment shoe	19
4. Device start-up	20
4.1. Seating adjustment	21
4.2. Checking the engine before start-up	22
4.3. Handbrake	23
4.4. Gear activation	23
4.5. Starting / stopping Cleanmeleon II	24
4.5.1. Handstart GXV 160 engine (engine start/stop)	24
4.6. Transportation	26
4.7. Working with the vehicle	27
4.8. Dismantling the tool	28
5. Hydraulic controls	29

5.1.	Hydraulic oil quantity (standard)	29
6.	Optional component:	30
6.1.	Large oil sump	30
6.2.	Large hydraulic pump	30
6.3.	Oil cooler/hydraulic oil filter	31
6.4.	Electrical system	31
7.	Maintenance and repair	32
7.1.	General information	32
7.2.	Tighten V-belt	34
7.3.	Lubrication	34
7.4.	Faults, causes and solution	35
8.	EC Declaration of Conformity	37
9.	Warranty guidelines	38
10.	Spare parts list	41
10.1.	Exploded drawing of rear wheel bearing	42
10.2.	Parts list of rear wheel bearing	42
10.3.	Exploded drawing of throttle handle	43
10.4.	Parts list of throttle handle	43
10.5.	Exploded view of foot lifting mechanism	44
10.6.	Parts list of foot lifting mechanism	44
10.7.	Exploded view of covering hood	45
10.8.	Parts list of covering hood	45
10.9.	Exploded drawing of frame	46
10.10.	Parts list of frame	47
10.11.	Exploded drawing of frame	48
10.12.	Parts list of frame	49
10.13.	Exploded view of drive / steering	50
10.14.	Drive/steering parts list	51
10.15.	Exploded view of drive/steering	52
10.16.	Drive/steering parts list	53
10.17.	Exploded view of steering console	54
10.18.	Parts list of steering console	54
10.19.	Exploded view of foot lifting mechanism	55
10.20.	Parts list of foot lifting mechanism	55
10.21.	Exploded view of steering wheel	56
10.22.	Parts list of steering wheel	56
10.23.	Hydraulic diagram	57
10.23.1	Cleanmeleon II without hydraulic lifting mechanism	57
10.23.2	Cleanmeleon II with hydraulic lifting mechanism	58

1. General information

Please observe the operating instructions provided by the manufacturer for the Cleanmeleon II and for the motor, as this is essential for problem-free use.

Only proper operation, observation of the safety information and appropriate maintenance and care guarantee the long-term use of your recently purchased machine.

Please ensure that only the operations required for the Cleanmeleon II are explained. Please refer to the enclosed operating instructions for the motor for all other information on the motor.

1.1. Purpose

The Cleanmeleon II is perfectly suited to cleaning slatted floors, sweeping up feed, shifting snow, sweeping paved areas and littering down barns.

The high-powered battery ensures easy operation with a variety of accessories.

1.2. Product information

1.2.1 Manufacturer

Westermann GmbH & Co. KG
Schützenhof 23
49716 Meppen
Tel.: 05931 / 49690-0
Fax: 05931 / 49690-99

1.2.2 Type plate

The type plate is located on the right-hand side of the steering column (in the direction of travel).

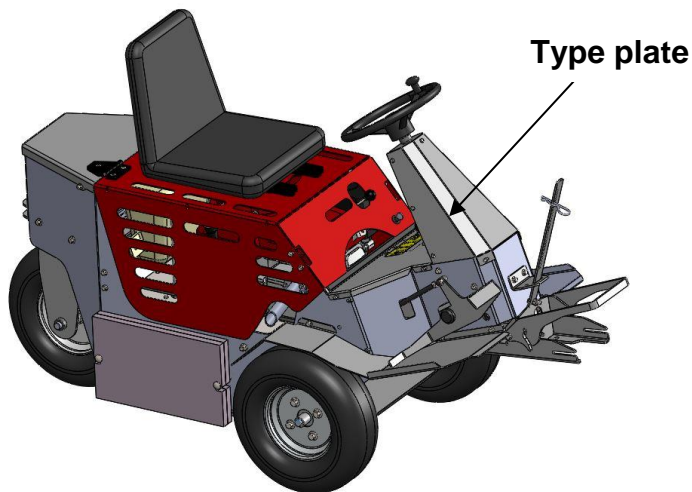

1.2.3 Ordering spare parts

When ordering spare parts or accessories, the type designation, machine number and year of construction should be stated.

Notice

The use of accessories and spare parts from other manufacturers is only permitted by arrangement with the manufacturer. Original accessories authorised by the manufacturer are recommended for safety reasons. The use of other accessories may exclude liability for any loss or damage that may arise.

1.2.4 Intended use

The Westermann Cleanmeleon II has been constructed exclusively for general use to clean slatted floors, sweep paved areas such as yards, streets, car parks, silo plates and barns, to shift snow, scatter feed, litter down barns, and other similar work.

It is not intended for any other use. The manufacturer does not accept any liability for any damage resulting from alternative use. The user bears the sole responsibility in such cases.

Intended use also includes adhering to the operating, maintenance and repair conditions specified by the manufacturer.

1.2.5. Technical datasheet

Specifications	Westermann Cleanmeleon II
GXV 160 / GXV 340 / B&S engine	4-stroke petrol engine
GXV 160 starter	Hand start
Honda GXV 340 starter	E-Start / Hand start
Briggs & Stratton starter	E-Start
Travelling speed in km/h	max. 6
Vehicle width in m	Approx. 0.8
Vehicle length in m	Approx. 1.7
Net weight in kg	Approx. 250
Max. Total weight in kg	450
max. right/left inclination in °	15
max. front/rear inclination in °	15
Min./max. front air pressure in bar	2.2 / 2.5
Min./max. rear air pressure in bar	2.2 / 2.5
Engine service / engine oil	Engine operating instructions
Hydraulic oil	e.g. Tellus Oil 46
Oil pressure in bar	Approx. 210
Hydraulic pump in cm ³	4.3 / 6
Oil sump in l	5 / 17
A-weighted emission sound pressure level	Honda GXV 160 / 85db Honda GXV 340 / 84db B&S / 84db

All technical specifications are approximate values. We reserve the right to modify the vehicle as a result of technical development.

2. Safety

These operating instructions include basic information that must be observed during operation, maintenance and servicing. Staff must read these operating instructions prior to start-up and use of the machine, and they must remain accessible to staff at all times.

Please observe the general safety instructions listed under the main point “Safety”, along with the specific safety instructions listed below other main points.

2.1. Safety information symbols in the operating instructions

Safety information which may endanger personnel and the vehicle if not observed, are specially marked with the following general hazard symbol.



Safety symbols in accordance with

For safety notices whose non-observance may cause hazards for the machine and its function, this word **Caution** is inserted.



Notice

Notices are marked as follows:

Notices applied directly onto the machine must be observed and kept in a fully legible condition.

2.2. Staff training and instruction



Users must be at least 16 years of age.
The Usage under influence of tiredness, illness, alcohol or drug influence is forbidden.

The Westermann Cleanmeleon II may only be used, maintained and repaired by staff who are familiar with it and who have been informed of the associated risks.

The area of responsibility, authority and supervision of staff must be regulated in detail by the operator. If staff do not have the necessary expertise, they must be trained and instructed. The operator must also ensure that the content of the operating instructions has been fully understood by staff.

Repair work that is not described in these operating instructions must only be carried out by authorised workshops.

2.3. Risk of non-compliance with the safety instructions

Failure to comply with the safety instructions may endanger people, the environment and the machine. Failure to comply with the safety instructions may result in the loss of any claims for damages.

In particular, failure to comply with the instructions may lead to the following risks:

- Danger to staff if working areas are not secured
- Failure of important machine functions
- Failure of prescribed methods of maintenance and repair
- Danger to staff due to mechanical and chemical effects
- Danger to the environment through leakage of operating materials.

2.4. Safe working practice

The safety information included in these operating instructions, the existing national regulations for the prevention of accidents, and any internal working, operational and safety regulations of the operator must be followed at all times.

The occupational safety and accident prevention regulations of the relevant professional unions are considered binding.

The safety information provided by the vehicle manufacturer must also be followed.



Operation on public roads is **NOT** permitted because the Cleanmeleon II does not meet the applicable legal regulations (the StVZO and StVO in the Federal Republic of Germany).

2.5. Safety instructions for the operator/user



Only operate the device in well-ventilated areas. **NEVER** use in closed spaces as poisonous carbon monoxide is generated during petrol combustion.
Danger of poisoning!



The oil level must be checked at regular intervals during short run times of less than 15 minutes!

During short run times, water and petrol can enter the oil quickly, which largely eliminates the oil's lubrication effect. This results in parts wearing faster and therefore a high risk of engine damage.

It is therefore recommended to change the engine oil regularly for short run times, or to leave the engine running for half an hour once or twice a week so that it is not operated only when cold.

- Before starting work, familiarise yourself with all of the devices, control elements and their functions. This must be done prior to operating the vehicle.
- Before starting the engine, always carry out the necessary checks (please refer to the engine operating instructions).
- Users must be at least 16 years old and are responsible for any persons, animals and objects located in the working area.

- Users must always wear close-fitting clothing. Avoid wearing loose clothing. Shoes shall not be slippery
- Familiarise yourself with how to operate the engine. Take note of how to switch off the engine in an emergency.
- Switch off the engine before carrying out any work on the vehicle. Ensure that there is no petrol in the tank if you need to tilt the machine.
- Do not place any objects on the engine or bring any highly flammable liquids near it.
- Do not overfill the petrol tank.
- Wipe up any spilt petrol. Only switch on the engine once the vapours have evaporated.
- Before start-up, check that any attached device and its connectors are securely fitted, and inspect for damage. The positioning of the hydraulic hoses should also be checked because slight damage can occur if they are trapped or pinched.
- Observe the permitted total weight (450 kg).
- Never leave the driving seat while the vehicle is in motion.
- Inspect and attach transportation equipment such as lighting, alarms and any protective guards.
- Check the area before moving and start-up (people, animals). Ensure sufficient visibility.
- It is not permitted for other persons to travel with you in the vehicle during work or transportation.

- The travelling speed should be adapted to the applicable road and traffic conditions. Avoid any sudden turning manoeuvres when travelling uphill, downhill, or across an incline.
- Remember to account for the forces that are exerted on the handling, steering and braking ability.
- Never stop in the work area.
- Never leave the vehicle running unattended.
- Before leaving the vehicle, ensure that it is positioned securely and cannot roll away.
- Hydraulic parts contain areas in which there is a risk of pinching and shearing.
- There is a danger that some parts may still continue to move after the vehicle has been switched off. Do not approach the vehicle during this time. Wait until it has come to a complete stop.
- The hydraulic system may be pressurised.
- Under high pressure, escaping fluids (hydraulic oil) may penetrate the skin and cause serious injury. In the event of injury, consult a doctor immediately. Risk of infection!
- Only connect the hydraulic hoses in an unpressurised state.
- Hydraulic hose lines should be replaced after a maximum service period of six years (including storage time of max. two years).

- Check hydraulic hose lines regularly and replace them in the case of damage or ageing. The replacement hose lines must correspond to the manufacturer's technical requirements.
- Leaks are a danger to the environment and must be fixed immediately.
- Use suitable tools when looking for leaks in order to avoid risk of injury.
- Only operate the Westermann Cleanmeleon II in well-ventilated areas.

2.6. Safety notice for maintenance, inspection and installation work

The operator must ensure that all maintenance, inspection and installation work is carried out by authorised and qualified staff who have been sufficiently briefed through intensive training in relation to the operating instructions.



As a general rule, all work should only be carried out on the unit when it has been stopped and the motor switched off. The procedure for stopping the unit described in the operating instructions must be observed.

When carrying out maintenance work on the raised device, always secure it using suitable supports.

Use suitable tools and gloves for maintenance, inspection and installation work.

Oils and grease should be removed in line with the instructions.

All safety and protective devices should be reinstalled and put back into operation immediately after completing the work.

The points listed in section “4 Starting up the machine” must be observed before restarting.

2.7. Unauthorised modifications and production of spare parts

Alterations or modifications to the machine are only permitted after consultation with the manufacturer. Original accessories authorised by the manufacturer are recommended for safety reasons. The use of other parts excludes liability for any resulting consequences.

2.8. Inadmissible modes of operation

The operational safety of the machine supplied can only be guaranteed through proper use in accordance with the operating instructions (Chapter 1 – General Information).

The limit values given in the datasheets must not be exceeded under any circumstances.

2.9. Warning symbols on the machine according to ISO 11684



Article-Nr. .94456

- Read and follow the operating instructions and safety notices before start-up.
- Never reach into the crushing or danger zone when there is a chance that parts may move.
- Do not touch any moving machine parts. Wait until they have come to a complete stop.
- Stay clear of the pivoting range when the machine is in operation.
- Follow the maintenance instructions found in the manual

Notice

All labels must be kept clean at all times. Missing or damaged labels must be replaced.

3. Westermann Cleanmeleon II



3.1. Typeplate (identification)

Type:

Year of construc-

Serial no.:

Notice

The type plate is an official certificate and must not be modified or otherwise concealed.

3.2. Storage



Store the Westermann Cleanmeleon II in a clean, dry place and ensure that it cannot be started accidentally.



Danger of accident!
Ensure that the Westermann Cleanmeleon II is positioned securely and cannot roll away.

Caution

Check the vehicle for any damage.

- Clean the Westermann Cleanmeleon II thoroughly as required. Dirt attracts damp and causes rust.
- Patch paint scratches if necessary

3.3. Description of product and accessories

The Westermann Cleanmeleon II has been developed for cleaning slatted floors.

This product can also be used to sweep paved areas such as yards, streets, car parks, silos and barns, to shift snow, to disperse feed, and to litter down barns.

The high-powered battery ensures easy operation with a variety of accessories.

The Cleanmeleon II can be driven forwards and backwards using the right foot pedal. It is also possible to rotate the Cleanmeleon II 360° on the spot by configuring the three wheels. This is particularly useful for remaining mobile on narrow slatted floors (alleyways).

The attachment is lowered or raised with the left foot pedal and locked at the desired height with a splint (for a device with hydraulic lifting mechanism, the attachment is lowered and raised by hand using a spool valve, the foot pedal is then omitted.)

The frame is made of a robust, hot-dip galvanised torsion-free steel structure, which makes the Cleanmeleon II perfect for use in the agricultural sector.

3.4. Attachments

The attachments listed below can be installed on the Westermann Cleanmeleon II. This provides a range of potential uses.

Attachments with standard swing arm:

- ASS 900 (double column slides)
- ASS 800 (double column slides)

Attachments with swing arm and attachment shoe:

- ASS 900 (double column slides)
- ASS 800 (double column slides)
- Pushing shovel (80 cm-130 cm)
- R900 (radial brush)
- R1000 (radial brush)
- Perfekt 1050 (axial sweeper)
- FA800 (feed processor)
- Litter device
- Snow plough (mechanical/hydraulic)
- Gap washer
- Trough washer



The attachments themselves must not be altered.



The safety regulations from Chapter 2.5 apply.



If the operator or a third party alters or changes the attachments, liability for any resulting damage shall expire.

3.5. Installing the attachments



The selected Westermann attachment should be attached or coupled to the Cleanmeleon II provided.



Danger of accident!
Ensure that the Westermann Cleanmeleon II is positioned securely and cannot roll away.

If ballast weights are prescribed, these must be attached to the fixing points provided on the Cleanmeleon II, in accordance with the instructions.

Special caution is required when attaching or coupling.

3.5.1. Attachment to swing arm

The attachment is mounted fixed to the swing arm.

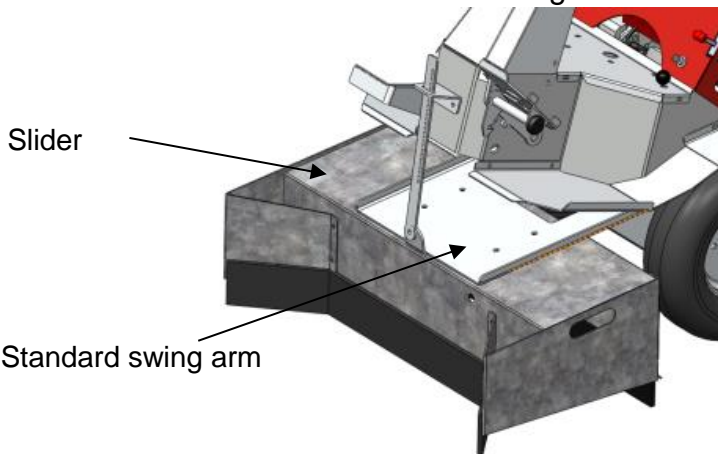

3.5.2. Attachment to swing arm with attachment shoe

The attachment shoe is screwed directly onto the attachment. The attachment shoe is then hooked into the swing arm with the attachment and secured using a locking device.

Example of ASS 900:

Slider with mounted attachment shoe

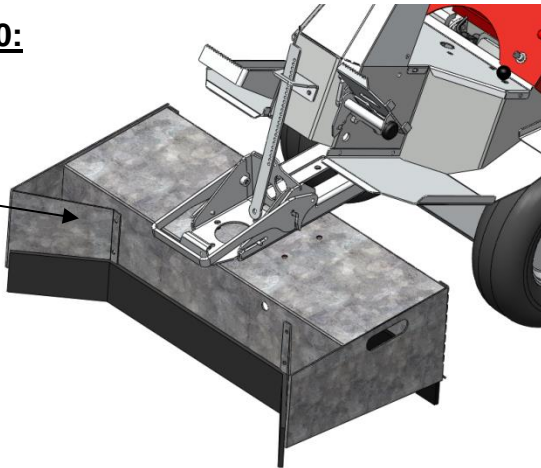

Locking device

Swing arm

Attachment

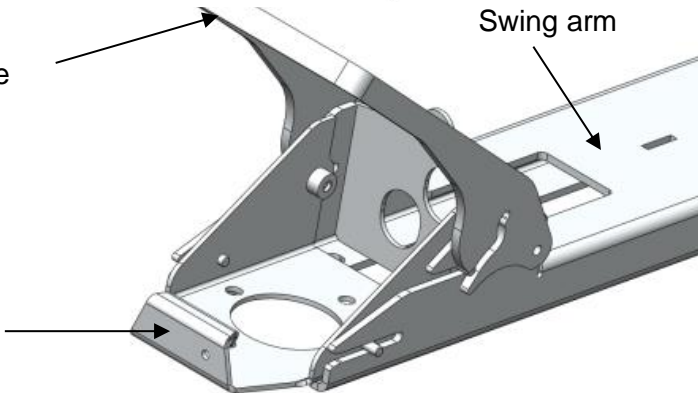

Check all mountings for dirt and damage, and clean or replace them as necessary.

Caution

Check proper attachment and corresponding safety mechanisms.

4. Device start-up



All maintenance, repair and alteration work can only be carried out on the Westermann Cleanmeleon II when stopped and with the engine switched off. The procedure for stopping the unit described in the operating instructions must be observed.

Danger of accident!

Ensure that the Westermann Cleanmeleon II is positioned securely and cannot roll away.



Danger of accident!

Ensure that the Westermann Cleanmeleon II is positioned securely and cannot roll away.



Please read the Cleanmeleon II and engine operating instructions with the associated setting instructions carefully before startup!

Ensure that the operating instructions have also been understood!



The safety regulations from Chapter 2.5 apply.



Before any start-up check levels of all liquids and correct if necessary. Please remove interval of changing from operating instructions

4.1. Seating adjustment

The lever for the seating adjustment (to push the seat further forwards or backwards) is on the left under the seat when facing the direction of travel.

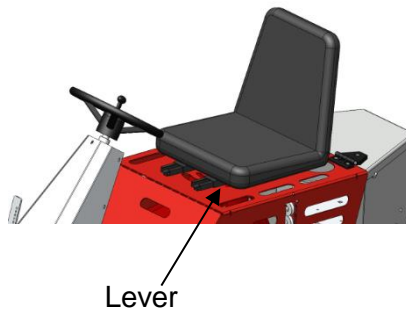

4.2. Checking the engine before start-up

Read the enclosed engine operating instructions for how to maintain and care for the engine. They include all the necessary maintenance steps such as changing the oil, changing the spark plugs, and engine inspection intervals.

Is there sufficient oil in the engine?

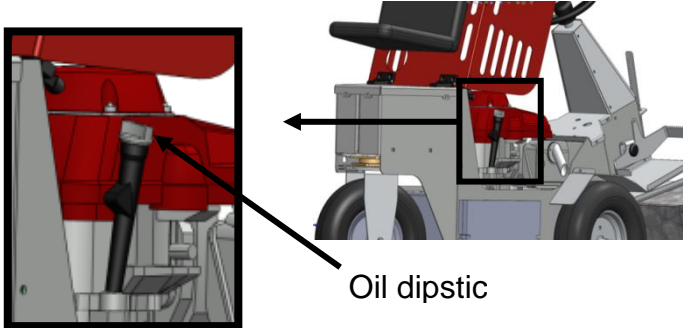

Is there sufficient fuel in the tank?

By positioning the fuel tank opposite the engine, residual fuel always remains in the tank.

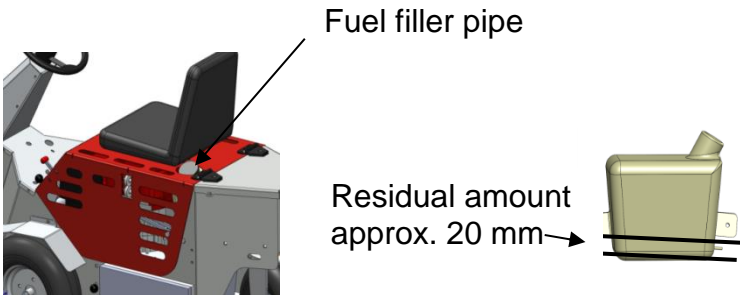

Caution

Consult the operating instructions for the engine for precise data.
Check the engine for any leaks or loose or damaged parts.

4.3. Handbrake

To prevent the device moving out of neutral, the handbrake can be applied for safety.

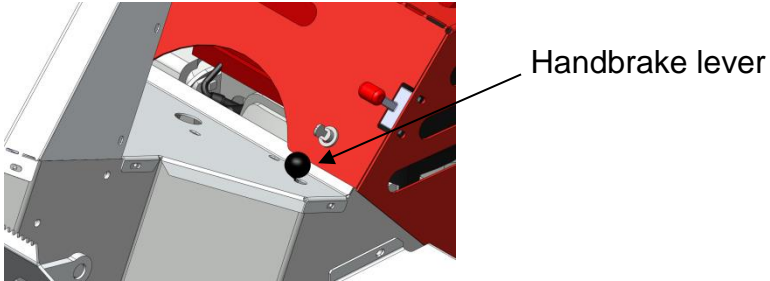

To apply the brake, pull the handbrake lever up and hook it into place.

4.4. Gear activation

If the device is to be moved manually, gear activation must be used.

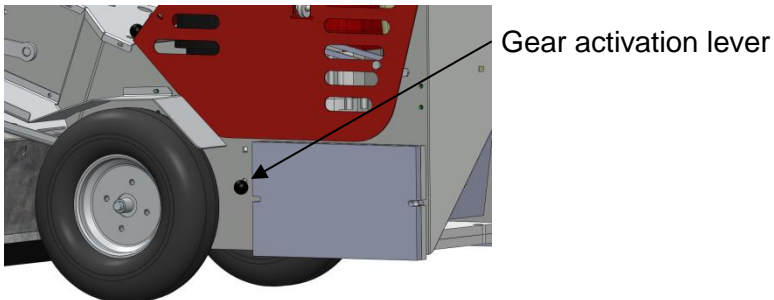

To activate the gears (move manually), pull the lever up and lock into place.

Caution

**Only activate gear activation
when the engine is switched off**

4.5. Starting / stopping Cleanmeleon II

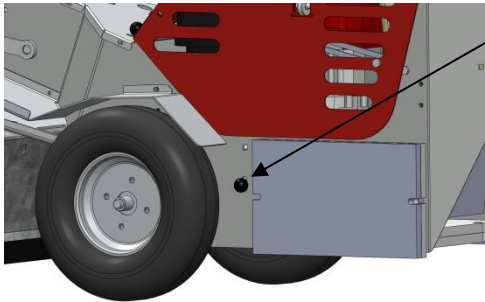

Gear activation lever

Caution

Ensure that the gear activation has been set correctly for operation. Push the lever in and engage (drive mode).

Notice

Has the fuel tap on the engine been opened?
Refer to engine operating instructions!

4.5.1. Handstart GXV 160 engine (engine start/stop)

Start the engine by pulling hard on the starter rope.

Cold start
(choke)

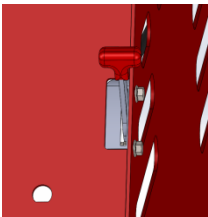

Lever fully up

Warm start

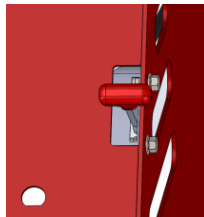

Lever in
medium
position

Standing/stop

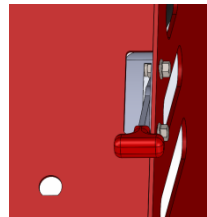

Lever fully
down

Caution

Once started, put the lever into the middle position and set the required speed.
Never operate the device in cold start (choke) position!

4.5.2. Handstart GXV 340 engine

Cold start (Choke)

Standing/Stop

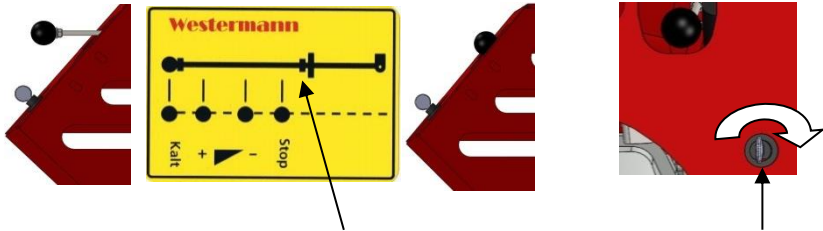

Within cold start the reward nut needs to be in front of the lead-in panel.

Start the engine by turning the ignition key.

Caution

Once started, put the lever into the middle position and set the required speed. **Never** operate the device in cold start (choke) position!

Stopping the engine the throttle handle needs to be in stop-position

4.5.3. Regulate speed

While using you can regulate the speed by the throttle handle!

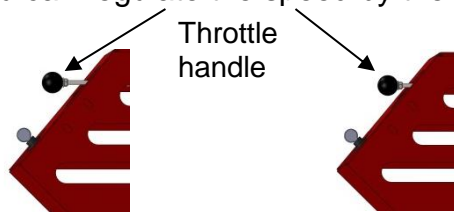

Pull out throttle handle: fast

Put in throttle handle: slow

4.6. Transportation



The safety regulations from Chapter 2.5 apply.

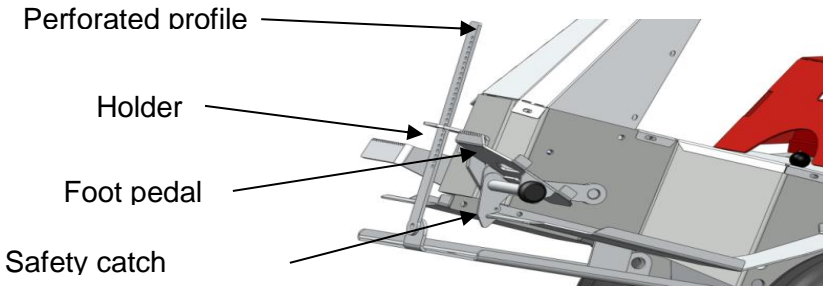

During transportation, lift the tool with the left foot pedal until the safety catch clicks. Also secure it against unintended lowering with a splint in the perforated profile.

If the Cleanmeleon II is fitted with a hydraulic lifting mechanism, the tool is operated by hand using a spool valve. Lift the tool up to the stop and secure it against unintended lowering with a splint in the perforated profile.

Caution

Mount the safety splint in the first hole **above** the holder.

Optional:

Right lever for lifting and lowering the attachment

Push the lever forward = lower attachment

Pull the lever backward = raise attachment

Optional:

Right lever for lifting and lowering the attachment

Push the lever forward = lower attachment

Pull the lever backward = raise attachment

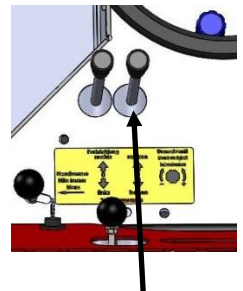

Right lever

Caution

Mount the safety splint in the first hole **above** the holder.

4.7. Working with the vehicle

Remove the safety splint from the perforated profile and lower the tool using the foot pedal or by hand using the spool valve until it touches the ground. You can now begin working with the vehicle.



The vehicle speed must be adapted to the ground conditions!

If the splint is reinserted into the perforated profile above the holder, the tool can only offset irregularities in the floor upwards (not applicable for the Cleanmeleon II with a hydraulic lifting mechanism).

If the splint is not inserted into the perforated profile, the tool can offset irregularities in the floor upwards and downwards (not applicable for the Cleanmeleon II with a hydraulic lifting mechanism).

A desired height can be set for the tool using the splint and the perforated profile.

In the Cleanmeleon II with hydraulic lifting mechanism, the desired height can be set by hand using a spool valve.

4.8. Dismantling the tool

Only for tools with attachment shoe.



Danger of accident!
Check attachment is positioned securely.



The safety regulations from Chapter 2.5 apply.

Set the attachment on the floor, unlock the locking device and pull out the attachment from the swing arm.

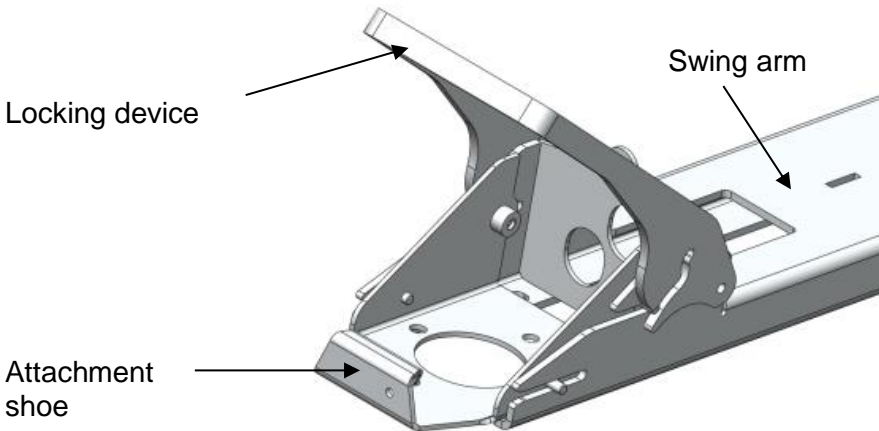
**Caution**

Check the attachments for any damage.

- Clean the attachment thoroughly if necessary. Dirt attracts damp and causes rust.
- Patch paint scratches if necessary.

5. Hydraulic controls

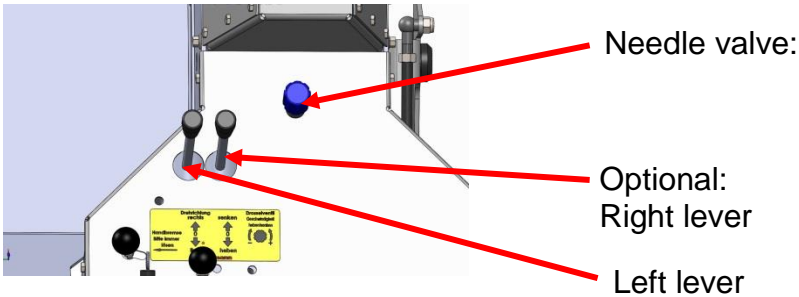

Needle valve for regulating the oil flow through the hydraulic lifting mechanism.

Left lever: Push the lever forward = brush rotates right
Pull the lever backward = brush rotates left

Right lever: Push the lever forward = lower attachment
Pull the lever backward = raise attachment

5.1. Hydraulic oil quantity (standard)

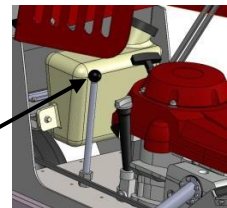

max. 5 l
min. 3 l

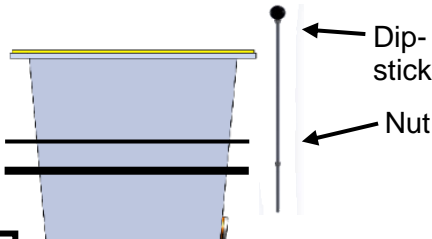

Caution

The oil level is checked using a dipstick!
Pull out dipstick: Oil level max. up to the
nut and min. approx. 3-4 cm below!

6. Optional component:

The Cleanmeleon II can be optionally equipped with a larger oil sump, a larger hydraulic pump, an oil cooler and a hydraulic oil filter.

6.1. Large oil sump

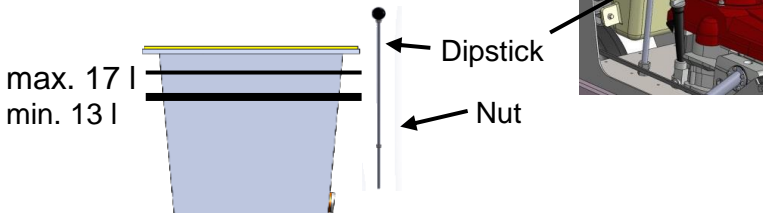

Caution

Do not install any weight plates under the Cleanmeleon II when using the large oil sump.

Caution

The oil level is checked using a dipstick!
Pull out dipstick: Oil level max. up to the nut and min. approx. 3-4 cm below!

6.2. Large hydraulic pump

A 4.3 cm³ hydraulic pump is installed as standard. It is also possible to install a 6 cm³ hydraulic pump.

Caution

The 6 cm³ hydraulic pump can only be installed in connection with the two-cylinder Briggs & Stratton engine and the large oil sump (17 l)!

Caution

Do not install any weight plates under the Cleanmeleon II when using the large oil sump.

6.3. Oil cooler/hydraulic oil filter

If the Cleanmeleon II is equipped with the large hydraulic pump (6 l) and large oil sump (17 l), an oil cooler and a hydraulic oil filter can also be mounted.

The oil cooler is installed behind the seat on top of the cover of the Cleanmeleon II frame.

The hydraulic oil filter is installed on the engine plate between the tank and the engine.

6.4. Electrical system

The Cleanmeleon II can be fitted with lights (working lights, rear lights and yellow warning beacon).

Caution

The lights may only be used in vehicles fitted with E-Start.

7. Maintenance and repair

7.1. General information



All maintenance, repair and alteration work can only be carried out on the Westermann Cleanmeleon II when stopped and with the engine switched off. The procedure for stopping the unit described in the operating instructions must be observed.

Danger of accident!

Ensure that the Westermann Cleanmeleon II is positioned securely and cannot roll away.



Danger of accident!

Ensure that the Westermann Cleanmeleon II is positioned securely and cannot roll away.



The safety regulations from Chapter 2.5 apply.

First check screws and nuts for tight fit after five hours of operation and then at regular intervals (approx. every 50 operating hours). Retighten if necessary.

- All torques M_A are reference values for metric standard threads in accordance with DIN 13. Coefficient of friction 0.14 – new screws unlubricated. The values have been recommended as reference values by different screw manufacturers. We cannot accept liability for use.
- Self-locking nuts must be renewed each time the unit is dismantled.

- Fuel feed lines should be replaced after a maximum service period of six years (including storage time of max. two years).
- Replace damaged and aged fuel feed lines.
- The replacement lines must correspond to the manufacturer's technical requirements.

A = thread size (strength class visible on the screw cap)

A	3.6	5.6	6.8	8.8	10.9	12.9
	M _A (Nm)					
M6	3.43	4.51	8.73	10.3	14.71	17.65
M7	5.59	7.45	14.22	17.16	24.52	28.44
M8	8.24	10.79	21.57	25.50	35.30	42.17
M10	16.67	21.57	42.17	50.01	70.61	85.32
M12	28.44	38.25	73.55	87.28	122.58	147.10
M14	45.11	60.80	116.70	135.27	194.17	235.36
M16	69.63	93.16	178.46	210.84	299.10	357.94
M18	95.13	127.40	245.17	289.30	411.88	490.34
M20	135.33	180.44	348.14	411.88	576.50	669.26
M22	162.40	245.17	470.72	558.98	784.45	941.44

7.2. Tighten V-belt

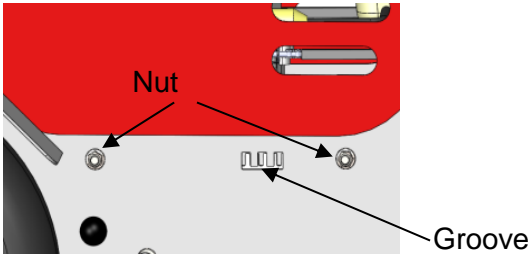

Loosen the nuts on the engine holding plate on both sides of the device and push back via the groove in the frame using a screwdriver.

The V-belt must be able to press in another 0.5 - 1 cm

7.3. Lubrication

The bearing for the steering is located on the rear wheel mounting.

To grease the bearings in the drive wheels, the wheels must be dismantled.

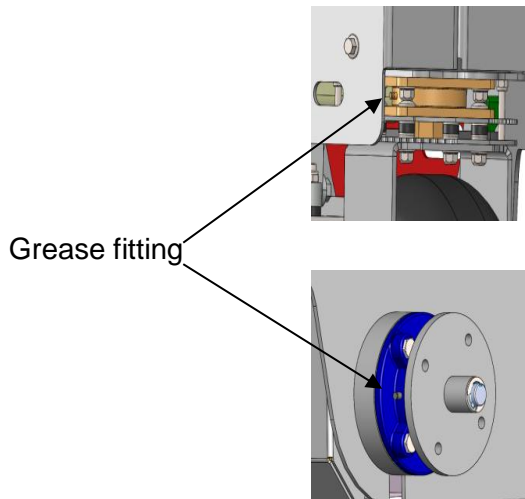

7.4. Faults, causes and solution

Fault	Cause	Solution
Vehicle does not start	<ul style="list-style-type: none"> - No fuel in the tank - Spark plug faulty - Air filter dirty - Choke valve does not close properly - Accelerator cable position not in start 	<p>Fill with fuel</p> <p>Replace spark plug</p> <p>Clean or replace</p> <p>Visit workshop</p> <p>Correct lever position</p>
Vehicle does not move	<ul style="list-style-type: none"> - Handbrake applied - Gear activation switched to idle - V-belt faulty / too loose 	<p>Loosen handbrake</p> <p>Engage shift rod</p> <p>Replace or tighten V-belt</p>

Fault	Cause	Solution
Attachment does not spin	<ul style="list-style-type: none"> - Hydraulic connections incorrect - Insufficient hydraulic oil in the oil tank - Spool valve faulty - Pressure or volume flow too low - Hydraulic motor faulty 	<p>Check connections</p> <p>Refill with oil</p> <p>Visit workshop</p> <p>Visit workshop</p> <p>Visit workshop</p>
Hydraulic lifting mechanism does not work	<ul style="list-style-type: none"> - Insufficient hydraulic oil in the oil tank - Spool valve faulty - Cylinder faulty - Needle valve complete closed 	<p>Refill with oil</p> <p>Visit workshop</p> <p>Visit workshop</p> <p>Open needle valve</p>

8. EC Declaration of Conformity

In accordance with EC Directive 89/392/EEC

The company
Westermann GmbH & Co. KG
Schützenhof 23
D-49716 Meppen (Emsl.)

declares under sole responsibility that its product, the

Westermann Cleanmeleon II,

to which this declaration refers, complies with the essential safety and health requirements of EC Directive 89/392/EEC and the EMC Directive 89/336/EEC applicable to it.

Meppen,



Alfons Westermann, Managing Director of
Westermann GmbH & Co. KG
TEL.: +49(0)5931 / 49690-0 Fax: +49(0)5931 / 49690-99

9. Warranty guidelines

The following guidelines are valid from 01/01/2002 for Westermann warranty claims.

- 1) For Westermann products in the consumer goods sector (private use) which were purchased from specialist Westermann retailers, the warranty period lasts for a period of 2 years from the date of sale to the end customer.
For Westermann products in the investment goods sector (commercial/professional use) which were purchased from specialist Westermann retailers, the warranty period lasts for a period of 1 year from the date of sale to the end customer.
- 2) The warranty covers defects caused by material and/or manufacturer faults. Any faults arising due to a product or manufacturing defect during the warranty period are accepted and remedied by means of repair or replacement parts by a specialist Westermann retailer.
- 3) Exceptions to this include wear and tear parts such as Bowden cables, starter rope, V-belts, bearings, clutch plates, tyres, air filters, spark plugs, fuel filters, oil filters, sweeping brushes, rubber strips, batteries, etc. provided that they do not exhibit any clear material defects.
- 4) Warranty claims shall generally be excluded in the case of insufficient maintenance and care. Regular maintenance and cleaning of the product according to the information in the Westermann operating instructions is vital. Damage due to maintenance and cleaning work carried out incorrectly cannot be accepted under the warranty.
- 5) The operating instructions and safety information for the respective product must be followed. Damage due to operating faults, improper application or use of accessories not released

by Westermann GmbH & Co. KG cannot be accepted under the warranty.

- 6) Please ensure that only original Westermann spare parts and Westermann accessories purchased from a specialist Westermann retailer are used. Using spare parts or accessories other than original Westermann spare parts or accessories can cause subsequent damage and increase the risk of accident. This subsequent damage is not covered by the warranty.
- 7) Only Westermann warranty claims shall apply from 01/01/2002. The information for the warranty claim is obligatory. No exceptions will be accepted. Warranty claims without the required information cannot be processed and shall be returned unprocessed for the missing information to be completed.
- 8) The Westermann machinery and warranty passport (warranty document) must be submitted to the Westermann after-sales service department within 4 weeks of purchasing the product. It must contain details of the end customer, the end customer's signature as confirmation, and a statement of use (private/commercial/professional).
- 9) The warranty period for original Westermann spare parts is 2 years for documented installation by a specialist Westermann retailer (the restriction under point 3 applies to wear and tear parts). For warranty claims relating to the provision of spare parts or warranty repairs, we request that you store the relevant parts for 2 months after submitting the warranty claim. We shall request the relevant part for inspection if applicable.
- 10) For logistics reasons, only Westermann customer service can order spare parts for warranty purposes from 01/01/2002 onwards. Our telephone ordering service is available from Monday - Friday between 08:00 - 16.30. Please state the item no.,

serial no. of the relevant device and the customer no. on tel.: +49(0)5931 / 49690-0. You can also order warranty spare parts by fax on +49(0)5931 / 49690-99.

- 11) If your warranty claim is rejected, the spare parts will be charged in line with your standard conditions of purchase. An invoice for the parts will also be issued if no warranty claim has been submitted to Westermann customer service after 4 weeks. If a Westermann spare part for warranty repairs cannot be delivered within a short period (2 working days) and you use an original Westermann spare part from your inventory to repair the damage, our customer service department will arrange delivery of a replacement free of charge once it is available or deliverable. If a spare part can no longer be delivered, you will be compensated the purchase price paid.
- 12) The parts or machinery claimed under warranty must be sent to the Westermann factory in Meppen. The freight charges will be refunded once the warranty is accepted.
- 13) To ensure fast processing, the warranty claim must be submitted to Westermann customer service at the latest 5 days after repairs have been carried out. Warranty claims submitted 3 months after repairs have been carried out can no longer be processed.
- 14) Any previous warranty guidelines and the conditions contained in Section 7 of the Terms & Conditions shall hereby cease to be valid.



Westermann GmbH & Co. KG

10. Spare parts list

Westermann Cleanmeleon II



10.1. Exploded drawing of rear wheel bearing

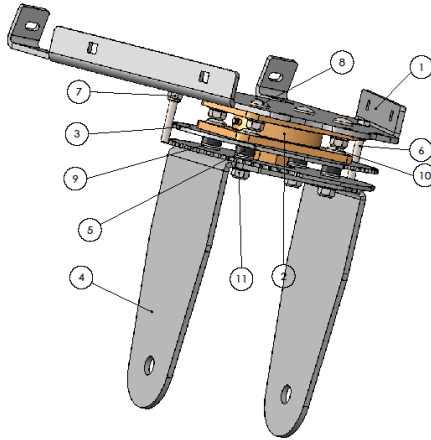

10.2. Parts list of rear wheel bearing

Item	Article no.	Description	DIN	Quantity	
				GXV 160	GXV 340
1	UNM005L	Bearing plate		1	
2	289439	Compression ball bearings DK-LS 200		1	
3	UNM144B	Rear suspension chain guide disk		2	
4	UNM012D	Rear wheel mounting fork		1	
5	105210080B	Spacer		4	
6	0703296	Hexagonal head screw M8x60	933	2	
7	7054355-1	Nut M8, self-locking	985	2	
8	7051499	Round-head screw M10x25	603	4	
9	040710	Disk M10	125	12	
10	0701536	Round-head screw M10x45	603	4	
11	0394010	Nut M10 ratched	6923	8	

10.3. Exploded drawing of throttle handle

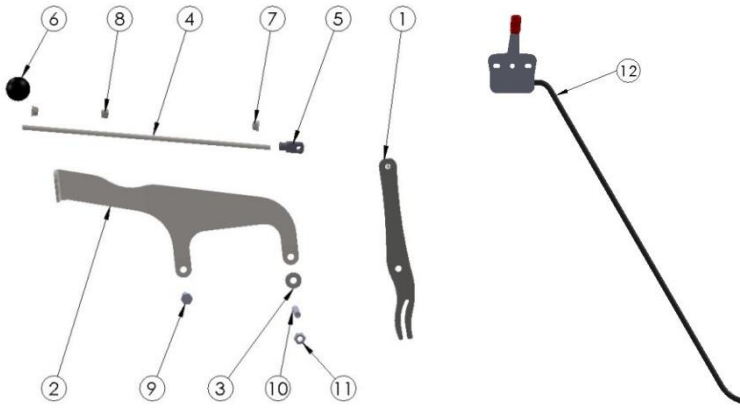

Honda GXV 340

Only Honda GXV 160 and
B&S

10.4. Parts list of throttle handle

POS	Artikel-Nr.	Bezeichnung	DIN	Menge
1	UNM032	Throttle handle		1
2	UNM033	Holder throttle handle		1
3	842040	Spacer 8,4x20,0x4,0		1
4	UNM095	Thread rod M6 L=310		1
5	7291129	Clevis M6x12	71751	1
6	0362302	Ball knob M6x25	319	1
7	039406	Hexagonal head screw M6 ratchet	6923	2
8	0704354	Nut M6 self-locking	985-8	1
9	7094000	Hexagonal head screw M8x20 ratchet		1
10	7093306-1	Setscrew M8x50	914	1
11	7054355-1	Nut M8 self-locking	985	1
12	B2062.02	Full Bowden cable 1320mm		1

10.5. Exploded view of foot lifting mechanism

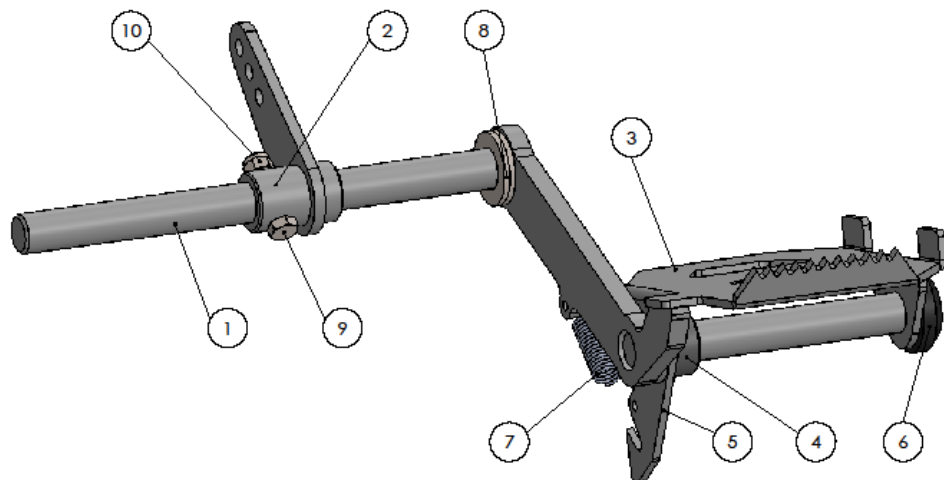

10.6. Parts list of foot lifting mechanism

Item	Article no.	Description	DIN	Quantity	
				GXV 160	GXV 340
1	UNM060D	Pedal axle		1	
2	UNM065A	Socket		1	
3	UNM042B	Left pedal		1	
4	7096907	Adjusting ring A20		1	
5	UNM040A	Foot lifting mechanism hook		1	
6	AB1008	20 wheel cover		1	
7	RZ-105X	Tension spring for foot lifting mechanism		1	
8	0704246	Disk A21	125	2	
9	0703292	Hexagonal head screw M8x40	933	1	
10	0704307	Nut M8, self-locking	985	1	

10.7. Exploded view of covering hood

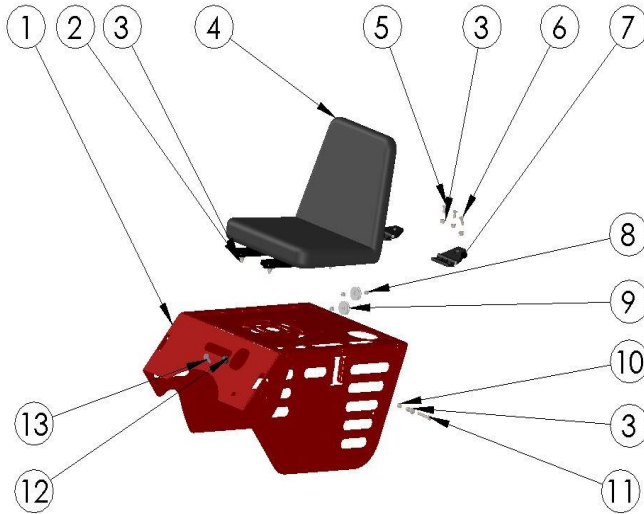

10.8. Parts list of covering hood

POS	Artikel- Nr.	Bezeichnung	DIN	Menge	
				GXV 160	GXV 340
1	UNM007K	Spool valve unit (RAL 3000)		1	
2	0703287	Hexagonal head screw M8x20	933	4	
3	039408	Nut M8 ratchet	6923	11	
4	500005	Upholstered seat with rails		1	
5	0087820	Hexagonal head screw M8x20	7991	4	
6	0703939-1	Hexagonal head screw M8x25	7991	2	
7	16679	Hinge		2	
8	064125100A	Spacer rope guide 6,4x12,5x10,0		4	-
9	0015933	Pulley E040-1		2	-
10	7054355-1	Nut M8 self-locking	985	2	
11	0057850	Hexagonal head screw M8x50	933	1	
12	P431A	Ignition lock		-	1
13	B805	Ignition key set		-	1

10.9. Exploded drawing of frame

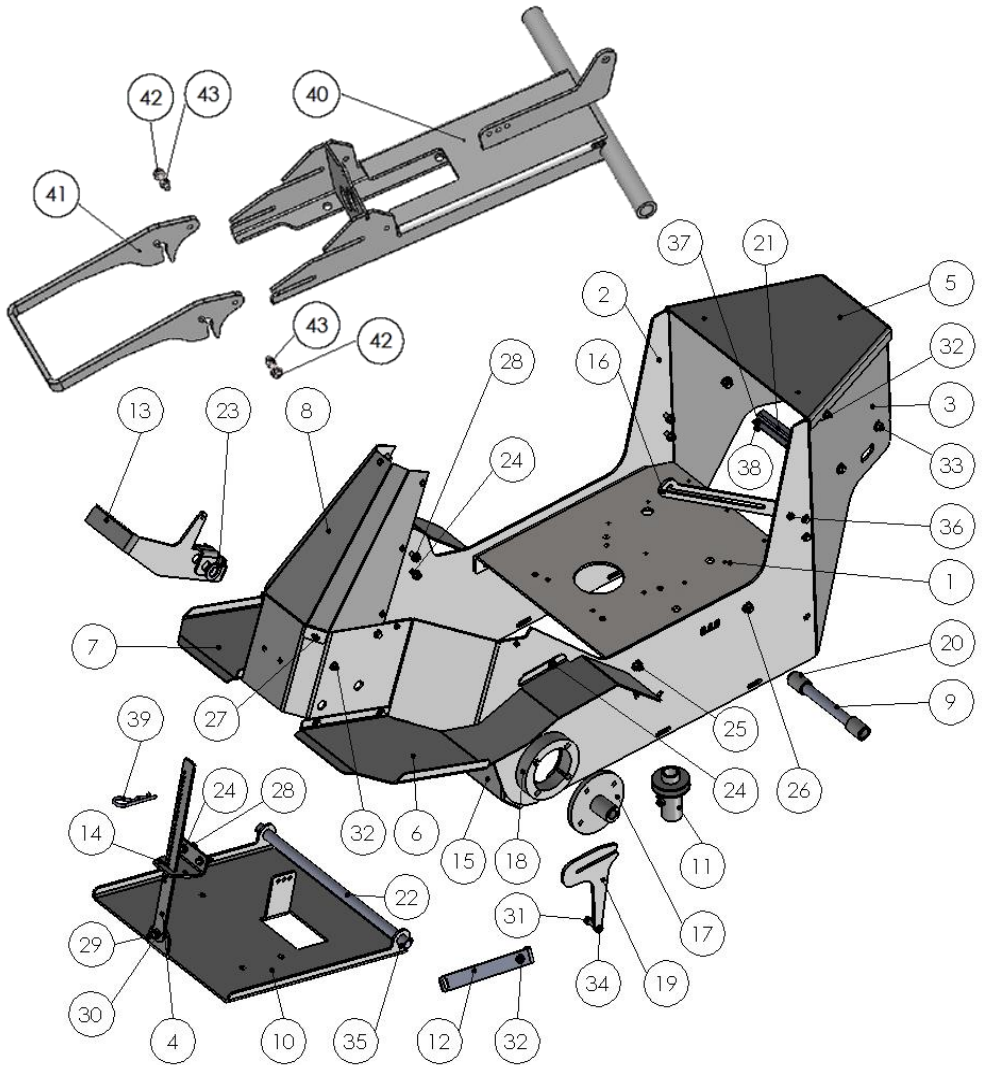

10.10. Parts list of frame

Item	Article no.	Description	DIN	Quantity	
				GXV 160	GXV 340
1	UNM006E	Engine plating			1
2	UNM001W	Right support			1
3	UNM002V	Left support			1
4	UNM004C	Adjustment lever			1
5	UNM017C	Cover			1
6	UNM054E	Left tread			1
7	UNM055E	Right tread			1
8	UNM028C	Steering column cover			1
9	UNM037B	Cylinder axle / rear wheel axle			1
10	UNM300C	Swing arm, special model			1
11	UNM330	Driveshaft 1:8 cone			1
12	UNM036_A	Tie rod (handbrake)			1
13	UNM041B	Right pedal			1
14	UNM068C	Holder adjustment lever			1
15	UNM074B	Guard plate			1
16	UNM079	Motor cover lock			1
17	UNM130A	Hub flange			2
18	UNM134B	Spacer			2
19	UNM35A	Locking plate torque bracket			1
20	UNM024	Spacing sleeve rear wheel			2
21	UNM038A	Battery clamping sheet			1
22	UNM071	Swing arm shaft			1

10.11. Exploded drawing of frame

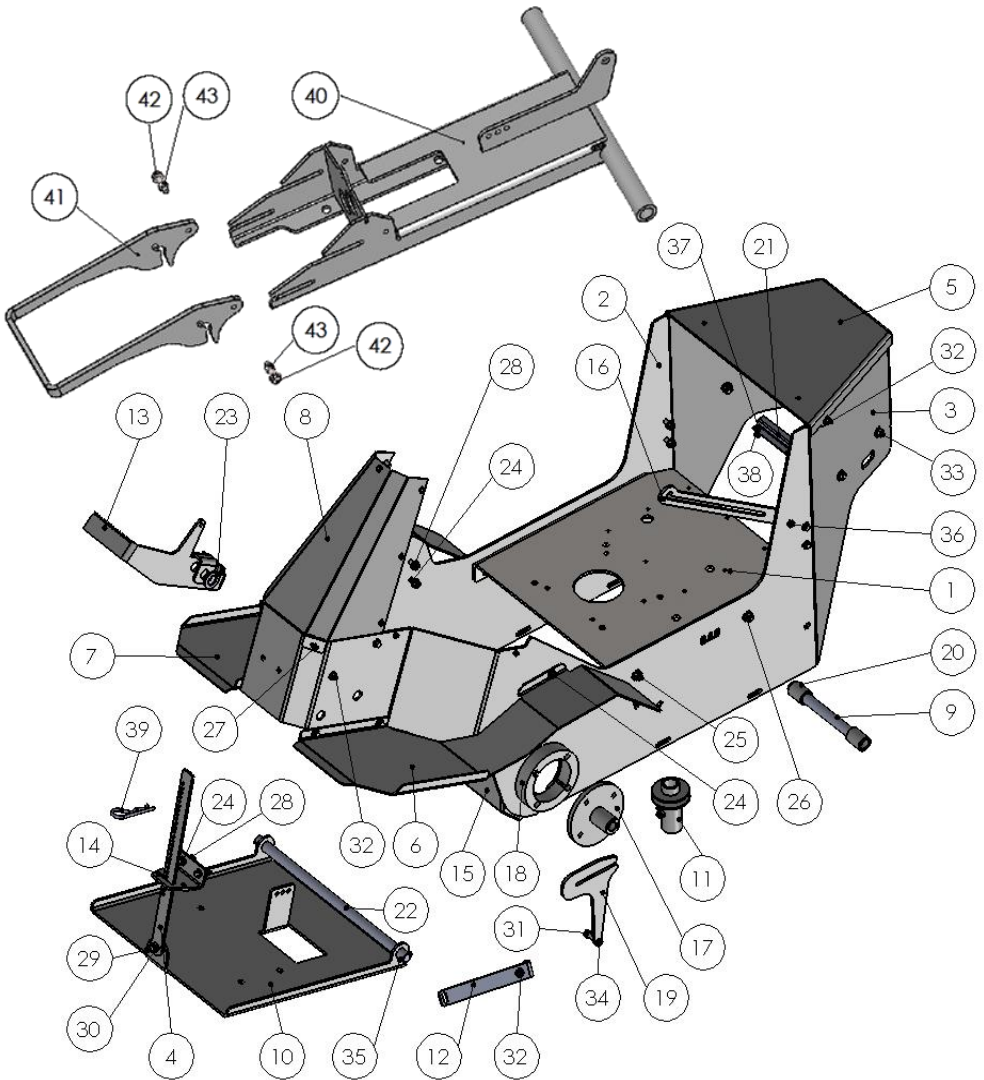

10.12. Parts list of frame

Item	Article no.	Description	DIN	Quantity	
				GXV 160	GXV 340
23	0704246	Disk 21 mm DIN 125	125		1
24	7095288	Hexagonal head screw 8x30 ratchet			10
25	7051499	Coach bolt M10x25	603		4
26	0394010	Nut M10 ratchet	6923		8
27	7092142-1	Self-tapping screw 6.3x19			13
28	039408	Nut M8 ratchet	6923		22
29	00571030	Hexagonal head screw M10x30	933		1
30	7054356-1	Nut M10, self-locking	985		1
31	7054355-1	Nut M8, self-locking			5
32	7094000	Hexagonal head screw M8x20 ratchet			15
33	7094709	Hexagonal head screw M10x25 ratchet	913		4
34	0703292	Hexagonal head screw M8x40	933		1
35	0721138-1	Coiled spring pin 6x30	1481		2
36	0703292	Hexagonal head screw M8x40	933		1
37	7094710	Hexagonal head screw M6x20 ratchet	913		2
38	039406	Nut M6, ratches	6923		2
39	7255013	Spring cotter 4x78			1
40	UNM10E	Rotation swing arm			1
41	UNM022E	Rotation swing arm lock			1
42	7095288	Hexagonal head screw M8x30 ratchet			2
43	7054355-1	Nut M8, self-locking	985		2

10.13. Exploded view of drive / steering

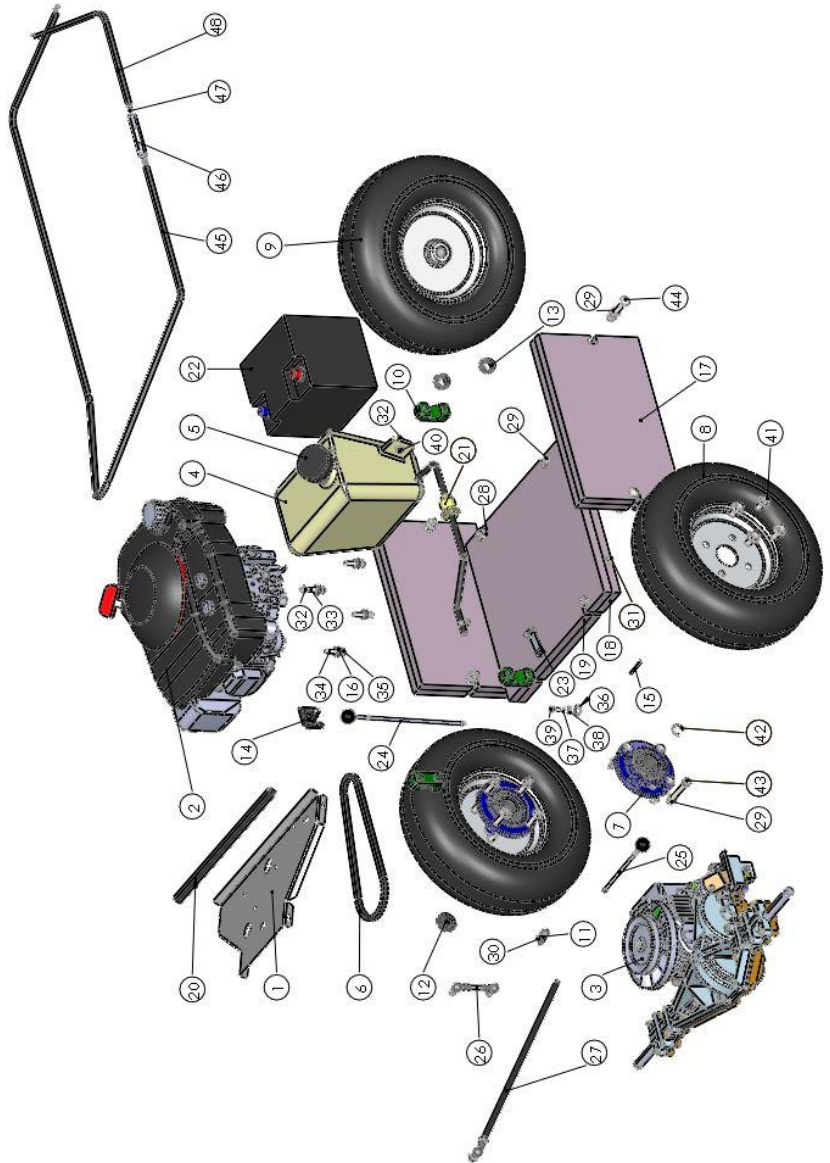

10.14. Drive/steering parts list

Item	Article no.	Description	DIN	Quantity	
				GXV 160	GXV 340
1	UNM5016	Spool valve unit		1	
2	GXV160UH2-N1-5-SD	GXV160		1	-
	GXV340T2	GXV 340		-	1
3	2000-031	Gear transmission incl. hydrostat		1	
4	751-0818C	Tank		1	
5	751-0603	GC300 filler cap		1	
6	A027.5	V-belt 13x700 Li		1	
7	25030.70.2.3	Ball bearings UCFC 207		2	
8	52280-2228	Drive wheel		2	
9	52340-2238	Pneumatic tyre (rear wheel)		1	
10	RS911228ZPP	Chain fastener		4	
11	UNM5011	BG angle joint standard swing arm		1	
	UNM5012	BG angle joint rotation swing arm		1	
12	AB1008	20 wheel cover		1	
13	7096907	Adjusting ring A20		2	
14	GX20000000	Deflector		1	
15	7293485	Dowel (4.76 x 4.76 x 50)		2	
16	105210080B	Spacer		4	
17	UNM101_A	Page weight		0 – 6	
18	UNM088A	Bottom counterweight (MB)		1	
19	UNM085	Bottom counterweight (OB)		1	
20	0369021_1	Edge protection		1	
21	UNM5013	Fuel line CM2		1	
22	5354459	12-V wet battery; 44Ah		1	

10.15. Exploded view of drive/steering

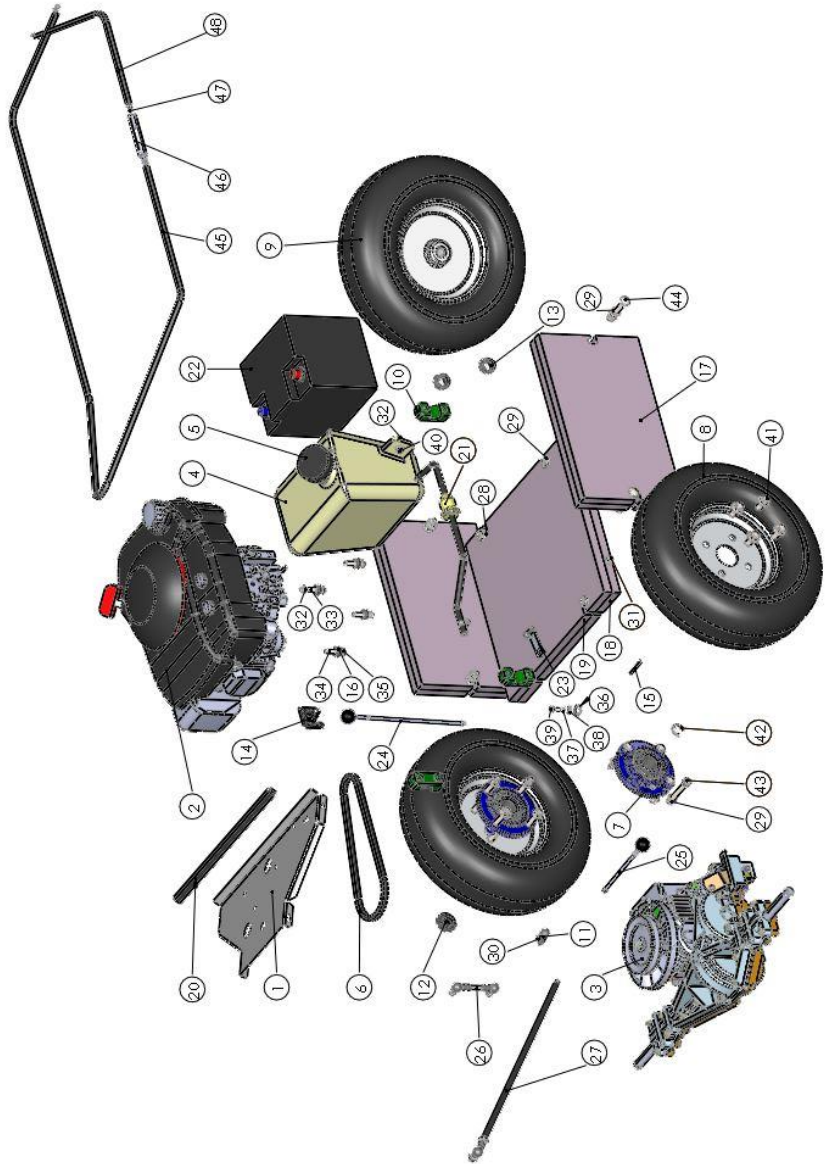

10.16. Drive/steering parts list

Item	Article no.	Description	DIN	Quantity	
				GXV 160	GXV 340
23	UNM5010	Sheet strap unit for declutching		1	
24	UNM5007	Parking brake unit		1	
25	UNM5006	Gear activation unit		1	
26	UNM5011	Angle joint unit		1	-
	UNM5012	Angle joint unit		-	1
27	UNM5005	Forwards/reverse threaded rod unit		1	
28	7051537-1	Round-head screw M10x50	603	4	
29	0394010	Nut M10 ratchet	6923	20	
30	7054356-1	Nut M10, self-locking		1	
31	7095288	Hexagonal head screw M8x30 ratchet		4	
32	7054355-1	Nut M8, self-locking	985	3	
33	0057850	Hexagonal head screw M8x50	933	1	
34	0703292	Hexagonal head screw M8x40	933	3	
35	0704035	Spring washer A8	1281 27	3	
36	040712	Disk A13	125	1	
37	0704034	Spring washer A6	127	1	
38	704239	Disk 6.4	125	1	
39	933.12.34.UNF	HBOLT 0.2500-20x0.75x0.75-N		1	
40	7095288	Hexagonal head screw M8x30 ratchet	933	2	
41	7093863-1	Hexagonal head screw M12x20 ratchet	6921	8	
42	7291955	Lock washer		2	
43	00571080	Hexagonal head screw M10x80	933	8	
44	7051541	Round-head screw M10x70	603	4	
45	06B1GP-2410MM	Chain (long) 2410mm		1	
46	1480.06GG	Tension lock M6		1	
47	VE38.732	Connector		4	
48	06B1GP-800MM	Chain (short) 800mm		1	

10.17. Exploded view of steering console

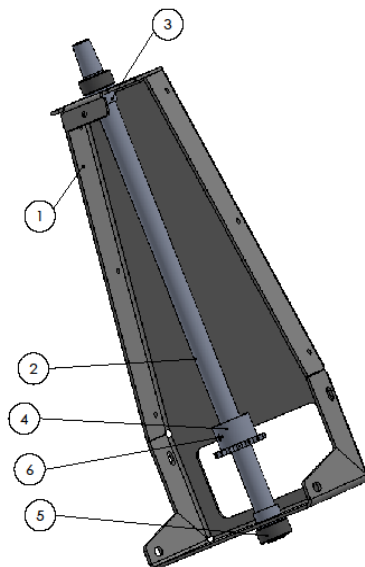

10.18. Parts list of steering console

Item	Article no.	Description	DIN	Quantity	
				GXV 160	GXV 340
1	UNM034B	Steering console		1	
2	UNM051A	Steering shaft		1	
3	008200300002	Plain bearings 20 x 25 x 15 white		2	
4	SE3816-DMR-20	Sprocket (steering chain) z=16		1	
5	7096907	Adjusting ring A20		2	
6	0704576	Threaded pin M6x8		1	

10.19. Exploded view of foot lifting mechanism

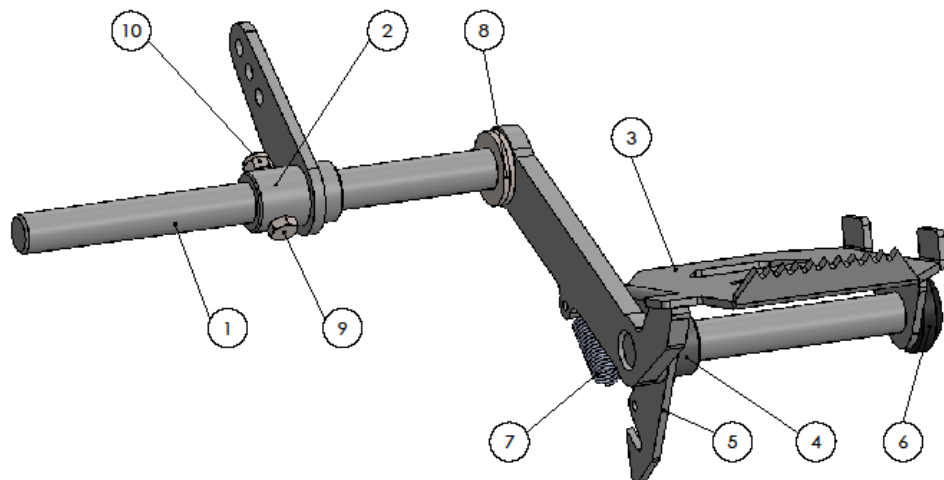

10.20. Parts list of foot lifting mechanism

Item	Article no.	Description	DIN	Quantity	
				GXV 160	GXV 340
1	UNM060D	Pedal axle		1	
2	UNM065A	Socket		1	
3	UNM042B	Left pedal		1	
4	7096907	Adjusting ring A20		1	
5	UNM040A	Foot lifting mechanism hook		1	
6	AB1008	20 wheel cover		1	
7	RZ-105X	Tension spring for foot lifting mechanism		1	
8	0704246	Disk A21	125	2	
9	0703292	Hexagonal head screw M8x40	933	1	
10	0704307	Nut M8, self-locking	985	1	

10.21. Exploded view of steering wheel



10.22. Parts list of steering wheel

Item	Article no.	Description	DIN	Quantity	
				GXV 160	GXV 340
1	VOL1930C2P	Steering wheel		1	
2	0703618	Cheese-head screw with hexagon socket M8x20	912	1	
3	0704035	Spring washer A8	127	1	
4	7054173-1	Disk 8.4	9021	1	

10.23. Hydraulic diagram

10.23.1 Cleanmeleon II without hydraulic lifting mechanism

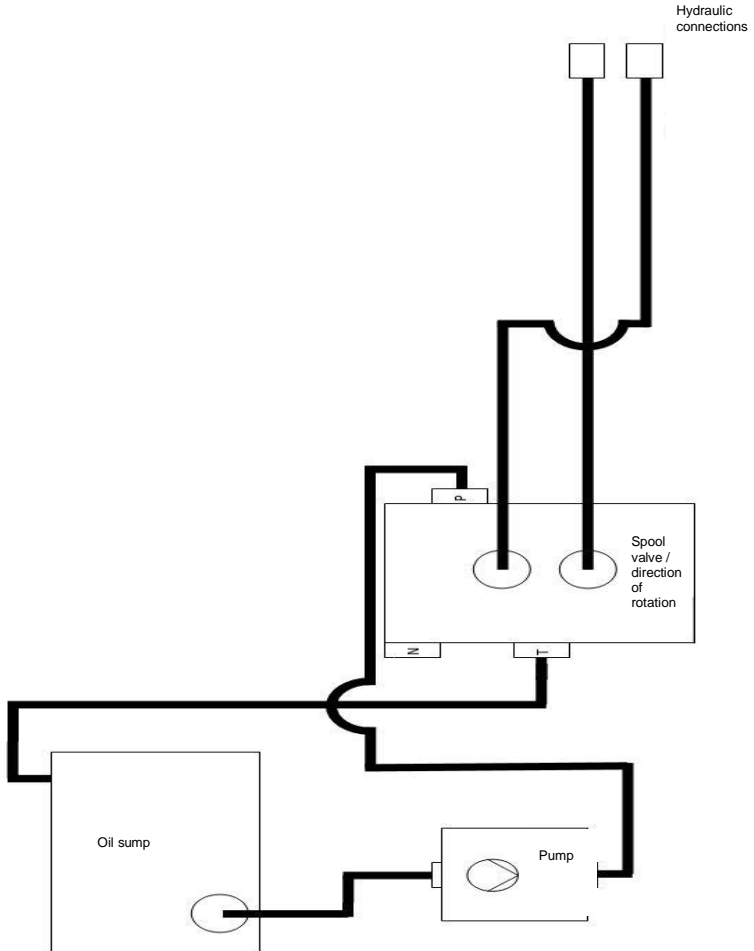

10.23.2 Cleanmeleon II with hydraulic lifting mechanism

